

**SURFACE MOUNT
DPST BALANCED MAGNETIC SWITCH
1000-65V BMS**



FEATURES:

- * Surface Mount Switch and Magnet
- * 18" Armored Cable, #22 AWG Wire Leads
- * Balanced Magnetic Configuration with Magnetic Tamper
- * Solid Aluminum Case
- * Lifetime Warranty
- * Safety Approvals



SWITCH AND MAGNET DIMENSIONS

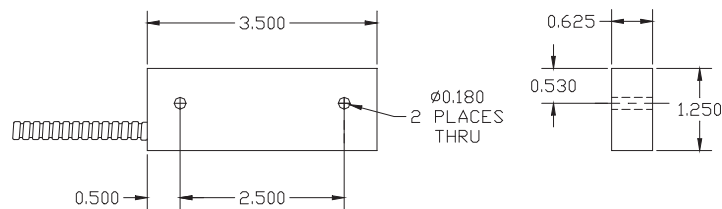

PRINCIPAL OF OPERATION: The Flair 1000-65V BMS Balanced Magnetic Contact utilizes three Form A high reliability Rhodium plated reed switches, one of the three reed switches being of different sensitivity, encapsulated in epoxy inside a solid aluminum case. This results in DPST configuration with magnetic tamper. When the rare earth magnet is in place and properly adjusted (balanced), the magnetic tamper switch will be in a state opposite to the other two switches. This normal configuration will change should one of the following occur; (1) switches 1 and 3 will change state by either the deliberate shunting of the magnetic field or if the door/window is opened, and (2) the addition of a magnetic field such as an external magnet will cause the magnetic tamper switch 2 to change state.

End-of-line resistors may be used to allow a pre-determined trickle of current to flow and permit operation from a supervised line at all times. Call Flair to request help with specifying the correct resistors. See Installation Instructions for more information.

WIRE COLOR CODE BASED ON LOOP TYPE WHEN MAGNET IS PRESENT

	Common	Closed	Open
Switch 1	Green	Red	
Switch 2 Magnetic Tamper	Black/White		Blue/White
Switch 3	Gray	Yellow	

SPECIFICATIONS

ELECTRICAL:

Circuit: DPST with Magnetic Tamper
 Voltage: 100VDC Max.
 Current: 50ma. Max.
 Wattage: 10 Max.

MECHANICAL:

Gap in steel Housing: 0" TO 1/2"
 Construction: Solid Aluminum