

**HEAVY DUTY SURFACE MOUNT
MAGNETIC CONTACTS
1000-66 SERIES**

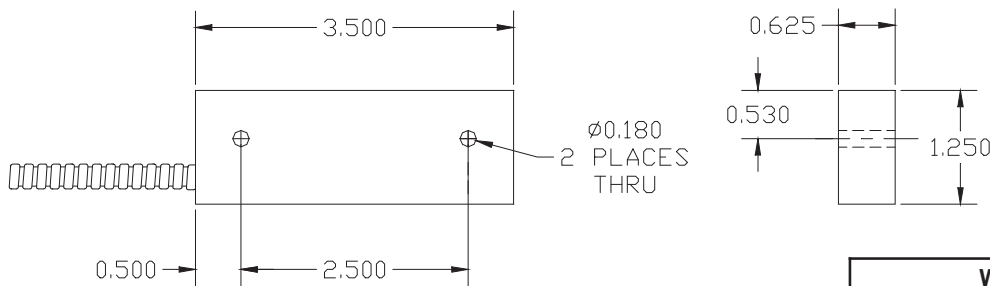

FEATURES:

- * 3 1/2" Heavy Duty Magnetic Contact
- * High Power Rating
- * Three Wire, SPDT Configuration
- * Solid Aluminum Case
- * 18" Armored Cable
- * Epoxy Sealed for maximum resistance to harsh environments
- * E.O.L. Resistors, Diodes, Supervisory Loops and Private Labeling Available
- * Lifetime warranty



SWITCH AND MAGNET

WIRE COLOR CODE WHEN MAGNET IS PRESENT			
	Common	Closed	Open
Loop	Green	Red	White

Part Number			1000-66-630	1000-66-634	1000-66-834
Power		Watts - Max.	25	100	100
		Watts - Min.	0.025	3	3
Voltage	Switching	VAC	150	120	500
	Breakdown	VAC	350	150	1000
Current	Switching	A	1	3	3
	Carry	A	6.2	3.6	4
Resistance	Contact	Ohms - Max.	0.1	0.5	0.5