

**RECESSED 3/4" DIA.
BALANCED MAGNETIC SWITCH
MSS200-7**



FEATURES:

- * 3/4" Dia. Recessed High Security Balanced Magnetic Contact
- * 12" #22 AWG Wire Leads
- * 3/4" Dia. Recessed Adjustable Rare Earth Magnet in Anodized Aluminum Housing
- * Self Locking in Steel and Wood
- * Colors: White, Brown, Black and Gray
- * Lifetime Warranty
- * Safety Approvals



MAGNET HOLDER AND Ø 1/4" X 1/2" RARE EARTH MAGNET
MAGNET HOLDER SCREWS IN AND OUT TO ADJUST GAP

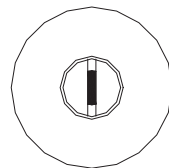

ADJUSTABLE MAGNET

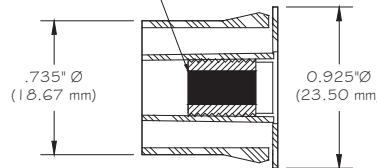

SWITCH

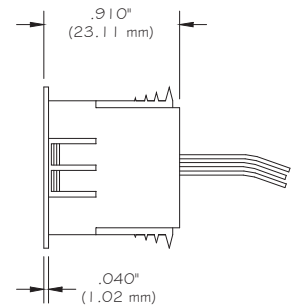
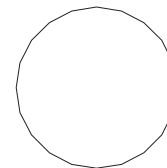

PRINCIPAL OF OPERATION: The Flair MSS200-7 Balanced Magnetic Contact utilizes two high reliability Rhodium plated reed switches of different sensitivity encapsulated in epoxy inside a recessed mounted fire retardant case. When the rare earth magnet is in place and properly adjusted, one switch will be open and the other will be closed. This normal configuration will change should one of the following occur; (1) switches 1 will change state by either the deliberate shunting of the magnetic field or if the door/window is opened, and (2) the addition of a magnetic field such as an external magnet will cause the magnetic tamper switch 2 to change state.

An end-of-line resistor may be used to allow a pre-determined trickle of current to flow and permit operation from a supervised line at all times. A change in current when the switch closes causes a signal to activate the alarm. See Installation Instructions for more information.

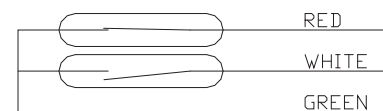

Electrical Configuration
Magnet Set At "Balance"

SPECIFICATIONS

ELECTRICAL

Circuit:	SPDT Balanced
Voltage:	130VDC Max.
Current:	50ma. Max.
Wattage:	10 Max.

MECHANICAL

Gap	3/8" TO 5/8"
Housing	Fire Retardant High Impact Plastic