

**RECESSED 3/4" DIA.
MAGNETIC CONTACT
PFC40-1**



FEATURES:

- * 3/4" Dia. Recessed Magnetic Contact
- * Terminals
- * Rare Earth Magnet
- * Self Locking in Steel Frames
- * Colors: White and Brown
- * Lifetime Warranty
- * UL 10C Classified Control - Miscellaneous Fire Door Accessories



MAGNET

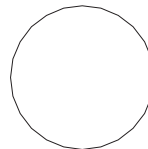
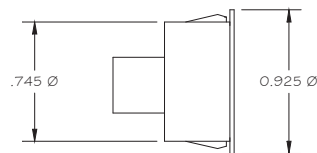

SWITCH

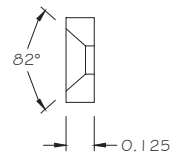
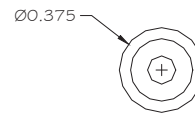
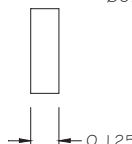
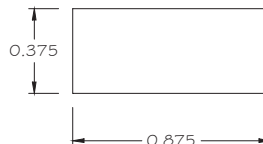
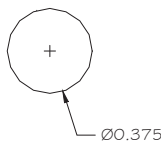
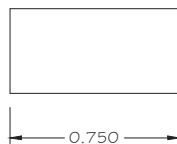
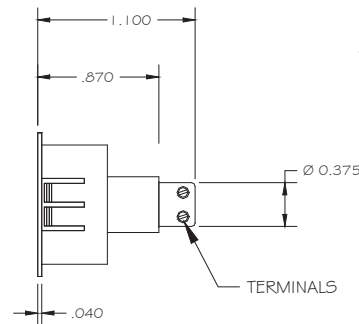

ALTERNATE RARE EARTH MAGNETS

| Part Number | Loop Type | Electrical Configuration | Gap in Steel | Maximum Initial Contact Resistance (Ohm) | Maximum Contact Rating (W) | Maximum Switching Voltage (VDC/VAC) | Maximum Switching Current (A) |
|-------------|-----------|--------------------------|--------------|--|----------------------------|-------------------------------------|-------------------------------|
| PFC40-1 | Closed | N/O | 1/2" | .100 | 10 | 100 | .500 |
| PFC40W-1 | Closed | N/O | 1" | .100 | 10 | 100 | .500 |