

**RECESSED 3/8" DIA.
MAGNETIC CONTACT
RMS56 SERIES**



FEATURES:

- * 3/8" Dia. Recessed Magnetic Contact
- * 3/4" Flange to cover oversize holes
- * 12" #22 AWG Wire Leads
- * Rare Earth Magnet
- * E.O.L. Resistors, Diodes and Supervisory Loops Available
- * Contacts and Magnets Available Separately
- * Colors: White
- * Lifetime Warranty
- * Safety Approvals



MAGNET

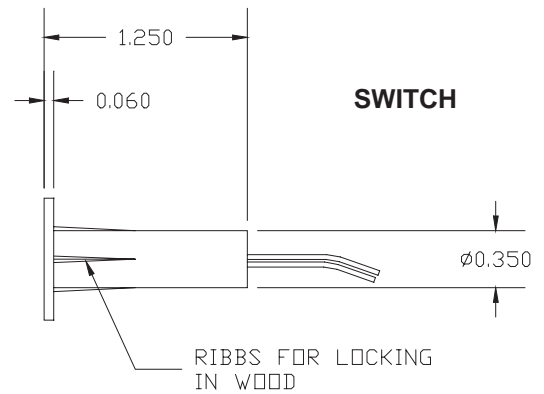
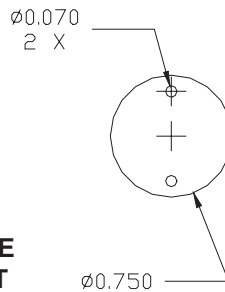
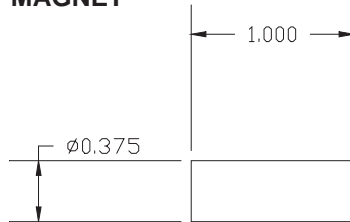

K = MAGNET WITH CASE, OTHERWISE SWITCH COMES WITH BARE MAGNET

Part Number	Loop Type	Electrical Configuration	Gap (Inch / mm)	Maximum Initial Contact Resistance (Ohm)	Maximum Contact Rating (W)	Maximum Switching Voltage (VDC/VAC)	Maximum Switching Current (A)
RMS56KW	Closed	N/O	1 (25.4)	.100	10	100	.500
RMS56W	Open	N/C	1 (25.4)	.100	3	30	.200
RMS60KW	Open/Closed	SPDT	1 (25.4)	.100	3	30	.200
RMS60W	Closed	N/O	1 (25.4)	.100	10	100	.100
RMS70KW	Open	N/C	1 (25.4)	.100	3	30	.200
RMS70W	Open/Closed	SPDT	1 (25.4)	.100	3	30	.200