

HEAVY DUTY SURFACE MOUNT MAGNETIC CONTACT 1000-65Y SERIES

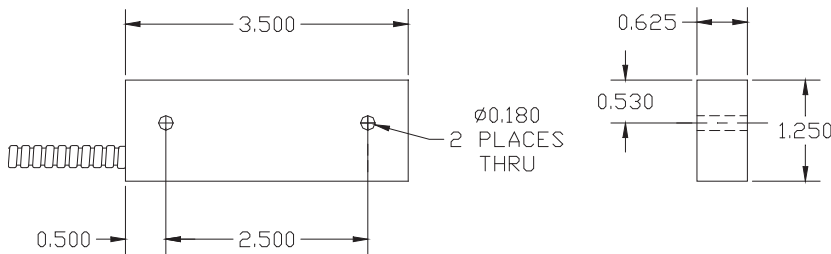

FEATURES:

- * 3 1/2" Heavy Duty Magnetic Contact
- * Solid Aluminum Case
- * 18" Armored Cable
- * Epoxy Sealed for maximum resistance to harsh environments
- * E.O.L. Resistors, Diodes, Supervisory Loops and Private Labeling Available
- * High Security Balanced Magnetic Configuration Available
- * Lifetime warranty
- * Safety Approvals



SWITCH AND MAGNET

WIRE COLOR CODE BASED ON LOOP TYPE WHEN THERE IS MORE THAN ONE SWITCH AND MAGNET IS PRESENT

		Common	Closed	Open
Loop	Switch 1	Green	Red	
	Switch 2	Black	Brown	

Part Number	Loop Type	Electrical Configuration	Gap	Maximum Initial Contact Resistance (Ohm)	Maximum Contact Rating (W)	Maximum Switching Voltage (VDC/VAC)	Maximum Switching Current (A)
1000-65Y	Closed	DPST	3"	.100	10	100	.500
1000-64Y	Open/Closed	DPDT	3"	.100	3	30	.200